

# 15mm - 307mm in just **3** pedestals

Upgrade from Traditional Paving  
to a Multipod Pedestal System

## TELESCOPING DESIGN

*Allows it to extend to over  
3 times its original height.*

The multipurpose functionality  
allows for an all-in-one system  
suitable for timber, tiles,  
concrete, stone!



- 3-size system offers height from 15mm up to 307mm.
- Easy to use! All units come completely assembled, as simple as getting them out of the box and immediately setting up the intended work area.
- Built-in slope adjuster to 6° without adding on bits and pieces.
- Very user friendly. Faster to set up onsite due to the multifunction rapid height twist lock adjustment system, saving time and money.
- The Multipod system height range takes out a lot of the guesswork when quoting projects as the substantial variable height in each of the 3 sizes is very forgiving.

## EASY TO USE, NO TOOLS NEEDED



### STEP 1

Flip Spacer for 3mm or 5mm and Clip Spacer into Multipod Twist Base for Slope Correction.



### STEP 2

Extend 1 or 2 Segments. Twist Clock-wise to Lock.



### STEP 3

Unscrew Counter-Clockwise for Fine Adjustment.

## INSTALL WITH EASE



Specially designed spacer tab included with all Multipods for 3mm, 5mm joints and inverted for timber decking systems.

Polypropylene recyclable material with 20% glass for added strength and durability.

The telescope design allows it to extend over 3 times its original height.

Locking pins fix the pedestals in place without the need for tools.

Base of Multipod is designed to create superior water drainage.

Cut for easy installation against walls and into corners.

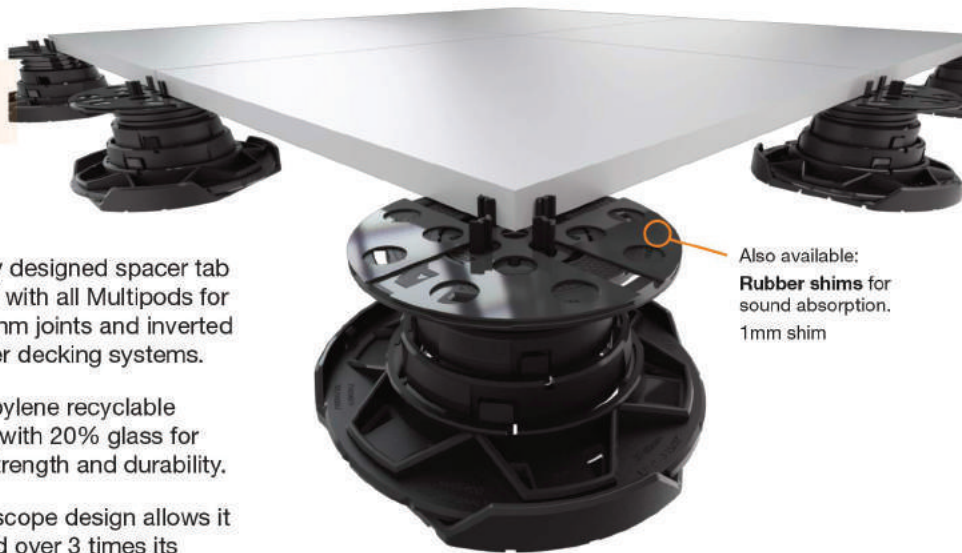

Also available:  
**Rubber shims** for sound absorption.  
1mm shim

## An Elevated Solution.

### 3 SIZES OFFER WIDE HEIGHT RANGE

*Multipod size range of 3 units compares to 8-9 of competitor units!*



**1** 15 to 32.4mm MULTIPOD



15mm (19/32")



32.4mm (1 1/4")



**2** 32 to 88mm MULTIPOD

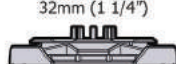

32mm (1 1/4")



88mm (3 15/32")



**3** 87 to 307mm MULTIPOD

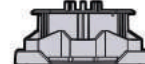

87mm (3 17/64")



307mm (12 3/32")